

## **NIDHI EASY FLOW 823**

MULTI SURGERY SUCTION /  
IRRIGATION PUMP

**NMS-PUMP**



ISO 13485 : 2016 CERTIFIED



CDSCO MD-5  
MANUFACTURING LICENSE

**NIDHI<sup>®</sup> Meditech Systems**  
(Complete Urological Solutions Since-1995)

# **NIDHI<sup>®</sup> Meditech Systems**

(Complete Urological Solutions Since-1995)

Dear Customers

We welcome you at Nidhi Meditech Systems. Nidhi Meditech Systems (NMS) is the concern, founded in the year 1995. We are, as such, amongst the first row of leading and laurel high tech Urology Products Manufacturer, approved universally. The company could brought forth innovative and most user's friendly medical equipment in the field of urology.

All our products are proved very much advantageous and cost effective for the medical society at large. We invite you to buy quite trustworthy urology products of ours such as Intra Corporeal Pneumatic Lithotripter (2 Models), Uroflowmetry (3 Models), Suction Irrigation Pump, Endoscopic Accessories and Urology Disposables and go on with full confidence irrespective of you being the actual user-surgeon urologist, medical professional or even a dealer.

We are an ISO:13485 2016 Certified company. We also hold the MD-5 CDSCO Manufacturing license. We are associated member of Government bodies like Federation of Indian Export Organization (FIEO). Our products are largely accepted across the globe and as a result, we are currently exporting our products in more than 45 countries.

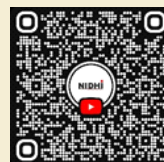

YOUTUBE



INSTRGRAM



FACEBOOK

# NIDHI EASY FLOW 823

## CONTROL UNIT NMS-CU-PUMP

### DESCRIPTION

- Nidhi Easy Flow Pump 823 is an irrigation and suction pump from Nidhi Meditech Systems.
- Nidhi Easy Flow Pump 823 offers you a controlled and continuous irrigation flow for excellent flow vision and Suction during all types of Endourology, Gynecology and laparoscopy surgeries.
- Nidhi Easy Flow Pump 823 comes with the large display for better visualization & Control.

### PERFORMANCE HIGHLIGHTS

- Nidhi Easy Flow 823 has 7 inch HMI Touch screen display.
- Irrigation Flow Range :-
  - 0-2000ml/Min continuous flow
  - Incremental Range - 10ml/Min by Touch Screen
- The Irrigation Flow will Start By touch screen & Foot switch.
- Nidhi Easy Flow 823 Offers to set the flow and pressure as per the surgeon's convenience also surgeon can adjust the flow and pressure as per their need during the running procedure
- Suction Range is 0-2000ml/Min and it will Start By Foot switch.
- Nidhi Easy Flow 823 has an Over Pressure cut off alarm on display with buzzer sound
- For Mini PCNL It has an intermittent On/Off cycle of 3 sec / 2 sec .
- The S S Connectors and silicon tubing are autoclavable.



### FEATURES

- It has an adjustable flow and pressure function.
- Generally recommended range flow and pressure are as per the Table.

Surgery	Flow Range	Pressure Range
<b>End Urology</b>		
• URS	up to 1000 ml/min	Up to 500 mmHg
• PCNL	up to 1500 ml/min	Up to 500 mmHg
• MPCNL	up to 1500 ml/min	Up to 500 mmHg
• RIRS	up to 300 ml/min	Up to 300 mmHg
• TURP	up to 1000 ml/min	Up to 500 mmHg
<b>Hysteroscopy</b>	up to 1000 ml/min	Up to 400 mmHg
<b>Laparoscopy</b>	up to 2000 ml/min	Up to 500 mmHg

# NIDHI EASY FLOW 823

## CONTROL UNIT NMS-CU-PUMP

### FEATURES

- Nidhi Easy Flow 823 Offers to set the flow and pressure as per the surgeon's convenience also surgeon can adjust the flow and pressure as per their need during the running procedure
- It has two types of irrigation options (1) continuous Irrigation by single Touch (2) Desired Irrigation Through Foot Switch
- It has a large HMI touch screen display of 7 inch for easy operation and clear vision.
- It has a powerful suction with 60 KPA pressure and max 2000ml / min. suction capacity.
- It has a boost feature which help to remove any air bubble before attachment of irrigation tube connector with scope. The Capacity of boost function is 1000ml / Min.
- Safety Standards :- Nidhi Easy Flow 823 complies with IEC 60601-01-01 standard and guidelines of Class 1 / Class A Equipment as per CDSCO.
- Certifications :- Nidhi Meditech Systems has successfully obtained the ISO 13485:2016 certification and CDSCO Manufacturing License for Nidhi Easy Flow 823.



### TECHNICAL SPECIFICATIONS:-

Input Voltage	100VAC - 260 VAC
Supply Frequency	50/60 Hz
Power Consumption	100v / 60Hz 1.10A 110 VA
	240V / 50hz 0.50A 118 VA
Operating Conditions	+10 c to 40 c
Relative Humidity	30% - 95%
Altitude above sea level	3000 mtr max
Storage transport & shipping conditions	20 C TO +60 C
Dimensions	350mm * 180mm * 340mm (W*H*D)
Weight	7.2 Kg



# NIDHI EASY FLOW 823

ALL STANDARD ACCESSORY OF  
**NMS-PUMP**



**NMS-CU-PUMP**

Silicon Irrigation Tube With Connector Set  
3 Mtrs + 3 Mtrs = 6 Mtrs

**NMS-PUMP-ISWC**



Combined Foot switch set  
for irrigation & suction

**NMS-PUMP-FS**

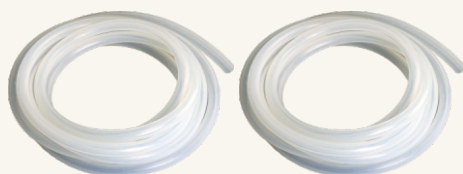

Silicon Irrigation Tube Without Connector Set  
3 Mtrs + 3 Mtrs = 6 Mtrs

**NMS-PUMP-ISTO**



Suction Filter  
**NMS-SF**



Silicon Suction Tubing Set  
3 Mtrs + 2 Mtrs = 5 Mtrs  
**NMS-PUMP-ST**



Suction Jar 2 Ltr  
**NMS-PUMP-JAR**



Mains Cable  
**NMS-PUMP-MC**

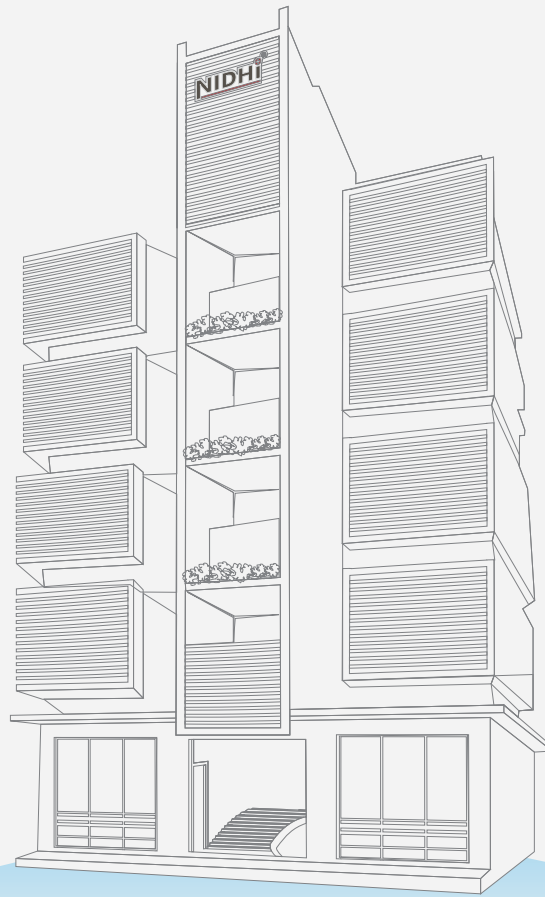

## Our Global Presence

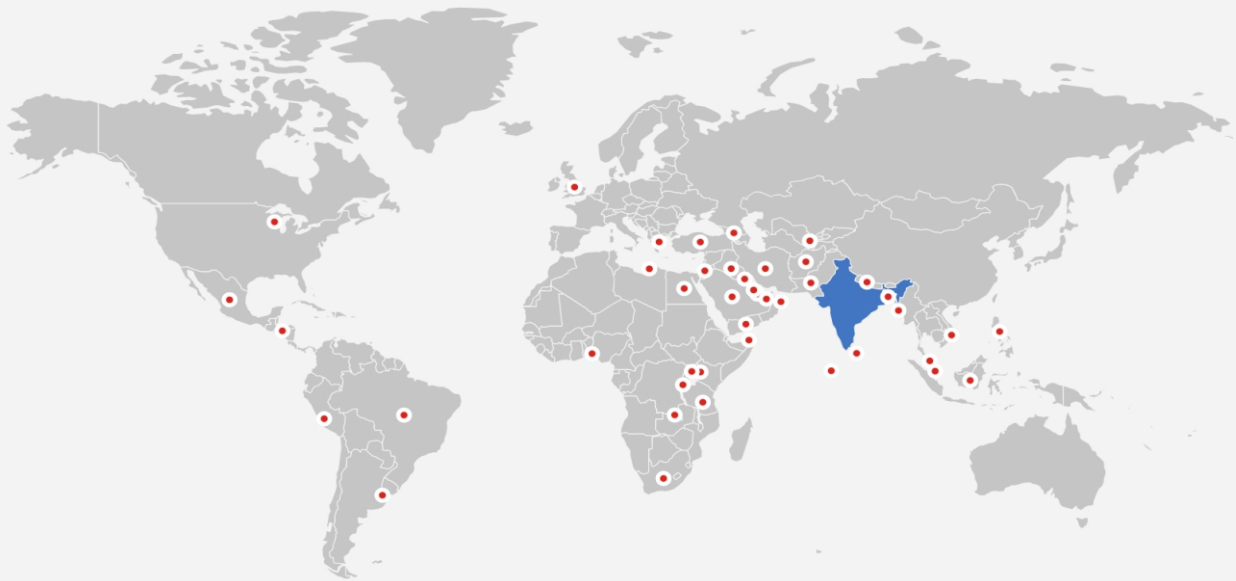

**NIDHI<sup>®</sup> Meditech Systems**  
(Complete Urological Solutions Since-1995)

## NIDHI CORPORATE HOUSE

No. H-28, H-29, H-30, Abhishek Estate-3,  
Near Asarwa Over Bridge, Opp. Haripura Bus Stop, Haripura, Asarwa, Ahmedabad-380016  
Cell / Whatsapp : +91-9510371980  
Email : [ndshah@nidhimeditech.com](mailto:ndshah@nidhimeditech.com), [info@nidhimeditech.com](mailto:info@nidhimeditech.com), [sales@nidhimeditech.com](mailto:sales@nidhimeditech.com)  
Website : [www.nidhimeditech.com](http://www.nidhimeditech.com)