

NIDHI[®]

NIDHI FLOW 8130

PC BASED WIRELESS (WI-FI) UROFLOWMETRY SYSTEM

NMS-8130



**Newly
Introduced**

NIDHI[®] Meditech Systems
(Complete Urological Solutions Since-1995)



www.nidhimeditech.com

NIDHI FLOW 8130

PC BASED WIRELESS (WI-FI) UROFLOWMETRY SYSTEM

NIDHI FLOW 8130

Uroflow 8130 is pc based wireless WI-FI uroflowmetry device. Nidhi flow 8130 has wireless link between digital flow transducer assembly and pc/ laptop. For patient privacy , the transducer assembly can be placed in another room. The WI-Fi range is up to 15 meters. The patient data can be store on the laptop/ pc. The report window has a facility to analysis the graph by changing flowrate and volume scales. Reports can be customized and printed in full-colour, containing patient data, results, comments and Graphs.

- **Flowrate vs Time**
- **Volume vs Time**
- **Siroky Nomogram**



FEATURES

- Model NIDHI FLOW – 8130 is advance version of uroflowmetry.
- NIDHI FLOW – 8130 is compact , portable and wireless device for practical everyday uroflowmetry study.
- NIDHI FLOW – 8130 is fully automatic device with Auto start , Auto Stop Function.
- Adjustable stand can be placed under micturation chair and to be used for both male and female patient as well as for children for comfort voiding.
- The communication between High precision Digital weight transducer assembly and PC / Laptop is via WI-FI (wireless).
- Due to WI-FI connectivity , it improves the range between high precision digital weight transducer assembly and PC / Laptop to give a patient some privacy.
- Real time plotting of graph.
- Flow rate vs Time graph.
- Volume vs Time graph.
- Nomogram (Siroky)
- Use definable pre - flow time 90 , 180 , 300 seconds.
- Operate in both auto mode and manual mode.
- Manual mode for Hesitancy.
- Display of voided volume level in beaker is visible on screen during testing.
- Real time display of measured parameters like volume , time and flow rate in decimal digit.
- Uroflowmetry report can be exported in to PDF Format.
- The report can be store for the extended management of patient database.
- No need for external WI-FI connection for NIDHI FLOW – 8130 device , WI-FI Modem will be given with the system.
- Compatible with any printer.

NIDHI FLOW 8130

PC BASED WIRELESS (WI-FI) UROFLOWMETRY SYSTEM

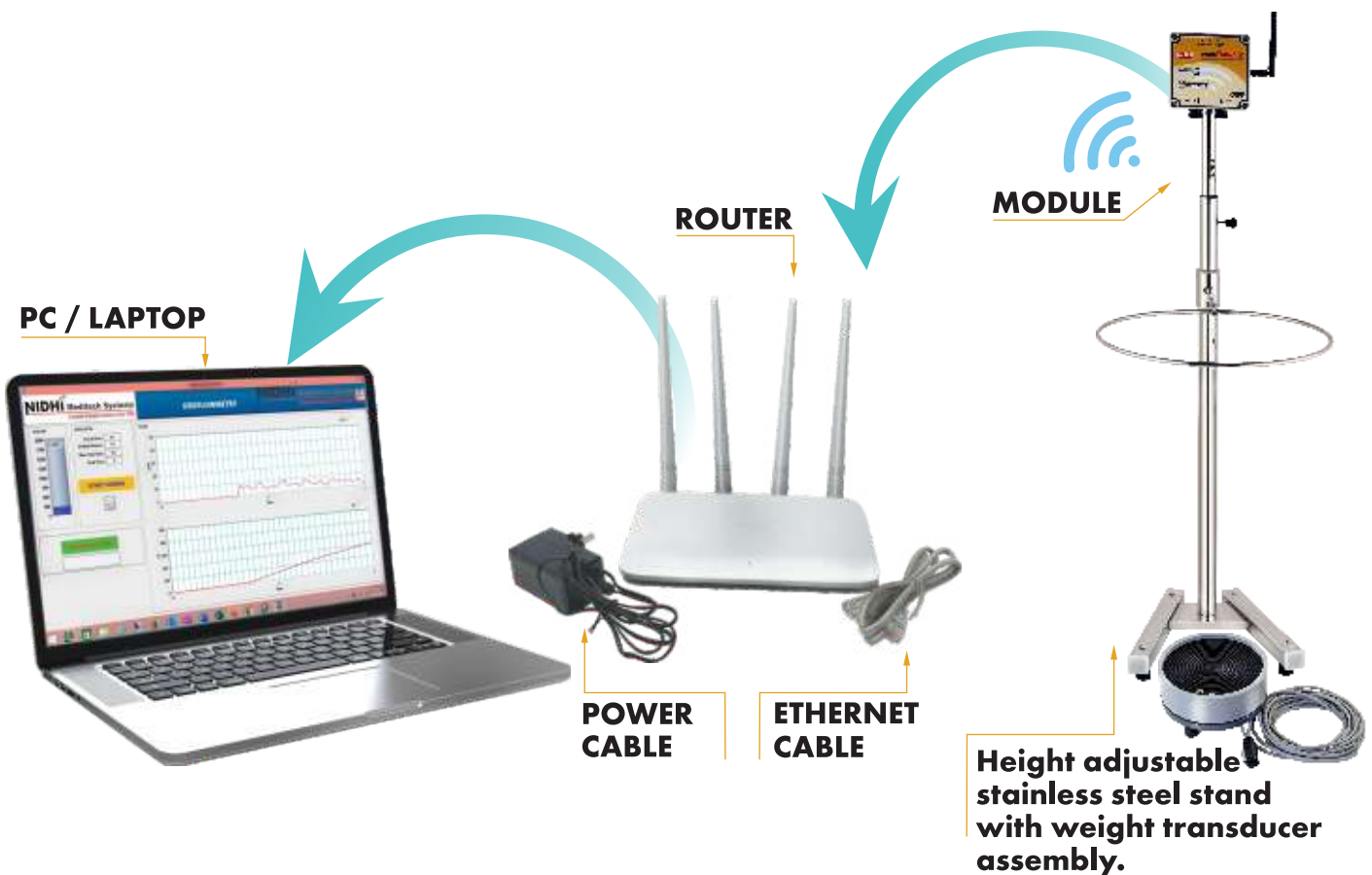

Technical Specification

- Wireless Range up to 25 meters
(Can be extended by the use of extended device)
- Flow Rate Measurement Range: 0-50ml/second.
- Flow rate accuracy : $\pm 2\%$
- Volume measurement scale : 0-1000 ml
- Volume Accuracy : $\pm 2\%$
- Modem Frequency : 2.4Ghz
- Power Supply : 80 VAC - 270 VAC / 50Hz

Software Installation Pre Requisites

- Processor : i3 or Later.
- RAM : 4GB OR More.
- HDD : 300GB OR More.
- Required Ethernet Port.
- Required WI-FI Connectivity.
- Operating System : Windows 8 OR Updated (Preferable Windows - 10)
- Microsoft Office : 2008 Version OR Updated.
- Adobe Reader
- Excel (Activated)
- Any Desk (Latest version is preferable)
- Printer Compatible with PC.(Color printer is preferable)

ALL STANDARD ACCESSORY OF
NIDHI FLOW 8130

PC BASED WIRELESS (WI-FI) UROFLOWMETRY SYSTEM
NMS-8130

Weight Transducer
Assembly with
NMS-WTA-8130



Height
Adjustable
stainless steel stand
NMS-HAS-8130



WI-FI ROUTER
NMS-WR-8130

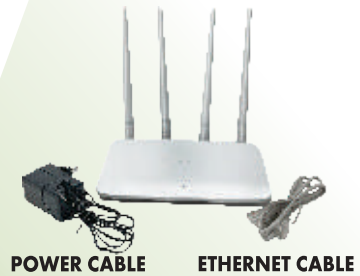

POWER CABLE

ETHERNET CABLE

FUNNEL
NMS-FNL



NIDHI⁺
WI-FI MODULE
NMS-WM-8130



PEN DRIVE WITH SOFTWARE
NMS-SW-8130



USB TO ETHERNET
CONVERTER
NMS-UEC-8130



URINE COLLECTION
BEAKER(1000ML)
NMS-UCB-Ltr.1



MICTURATION CHAIR WITH
BACK REST AND ARM
MICTURATION CHAIR
(OPTIONAL)

NIDHI FLOW 8130

PC BASED WIRELESS (WI-FI) UROFLOWMETRY SYSTEM

- 1) FLOWRATE VS TIME
- 2) VOLUME VS TIME

UROFLOWMETRY

Pateint Info:

Patient	: VIRAT	Date	: 8/10/2021
Case ID	: 569	Sex	:
D.O.B.	: //	Weight	: Kg
Age	: Years	Ref. Dr.	:
Position	:		

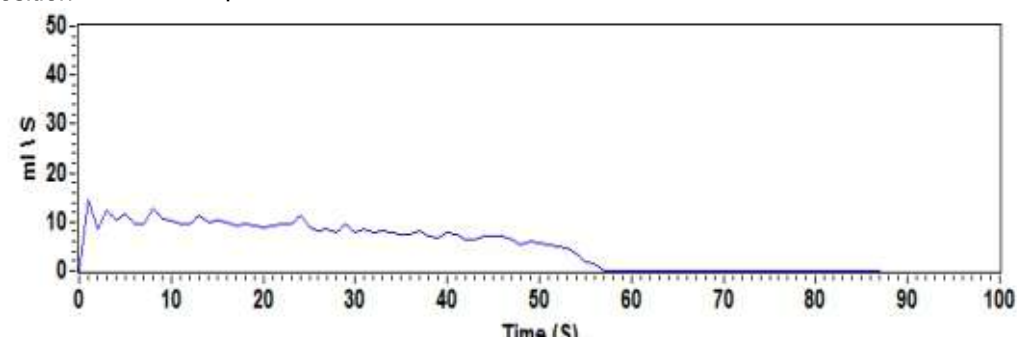

Time (S)

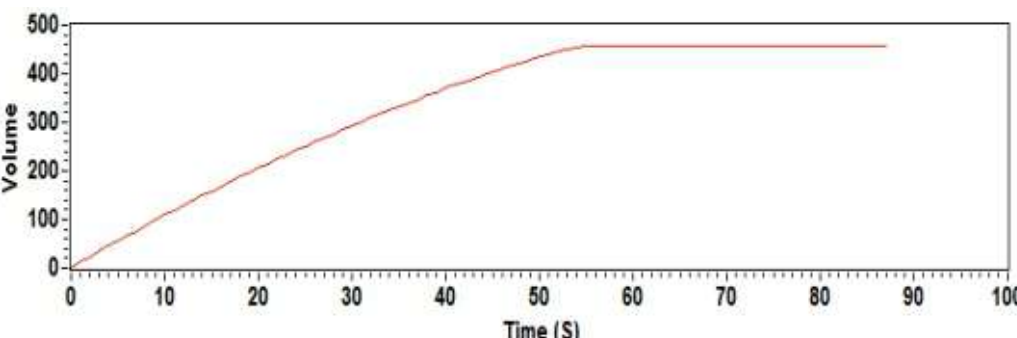

Time (S)

Uroflow Results :

Evaluation :		Analysis:	
VOID	: 14.7/458/---	INV. Dr.	:
Voided Volume	: 458 [ml]	Diagnosis	:
Max. Flow rate	: 14.7 [ml/s]		
Avg. Flow rate	: 8.2 [ml/s]		
Voiding Time	: 56 [sec]	Advice	:
Flow Time	: 56 [sec]		
Time to Max. Flow	: 1 [sec]		
Hesitancy	: 0 [sec]		

NIDHI MEDITECH SYSTEM-INDIA
www.nidhimeditech.com

NIDHI FLOW 8130

PC BASED WIRELESS (WI-FI) UROFLOWMETRY SYSTEM
SIROKY NOMOGRAM

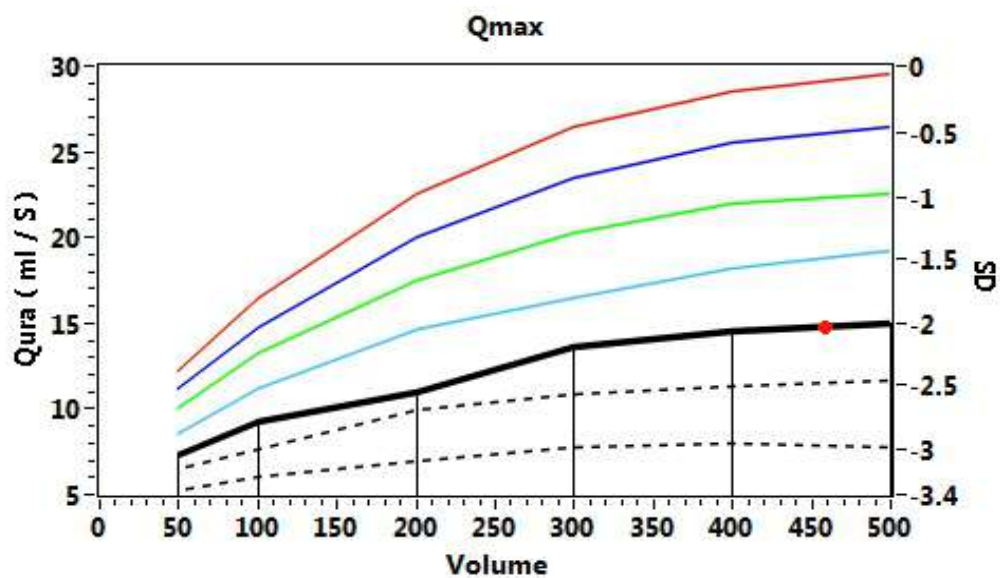
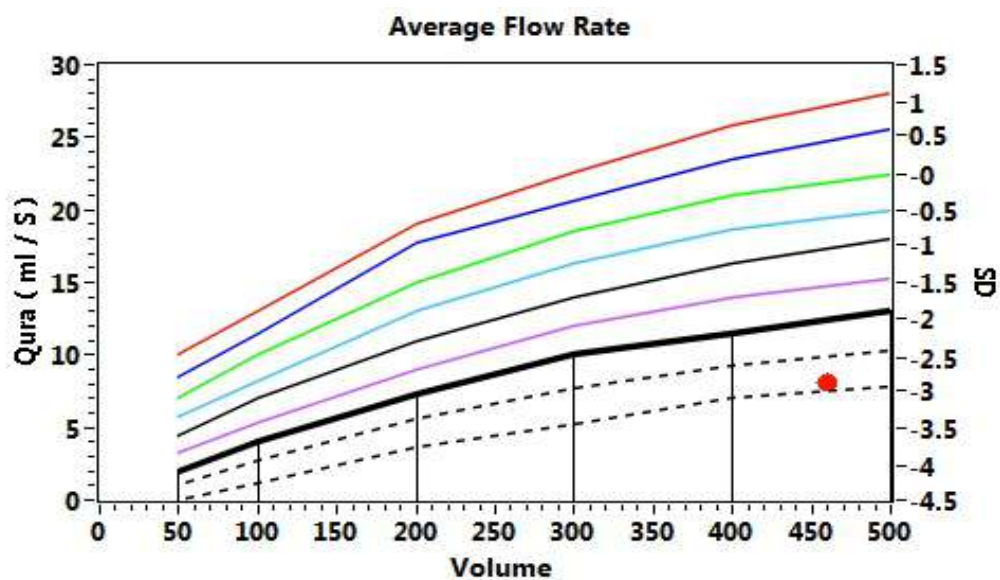

NIDHI FLOW 8130

PC BASED WIRELESS (WI-FI) UROFLOWMETRY SYSTEM
WORKING MECHANISM

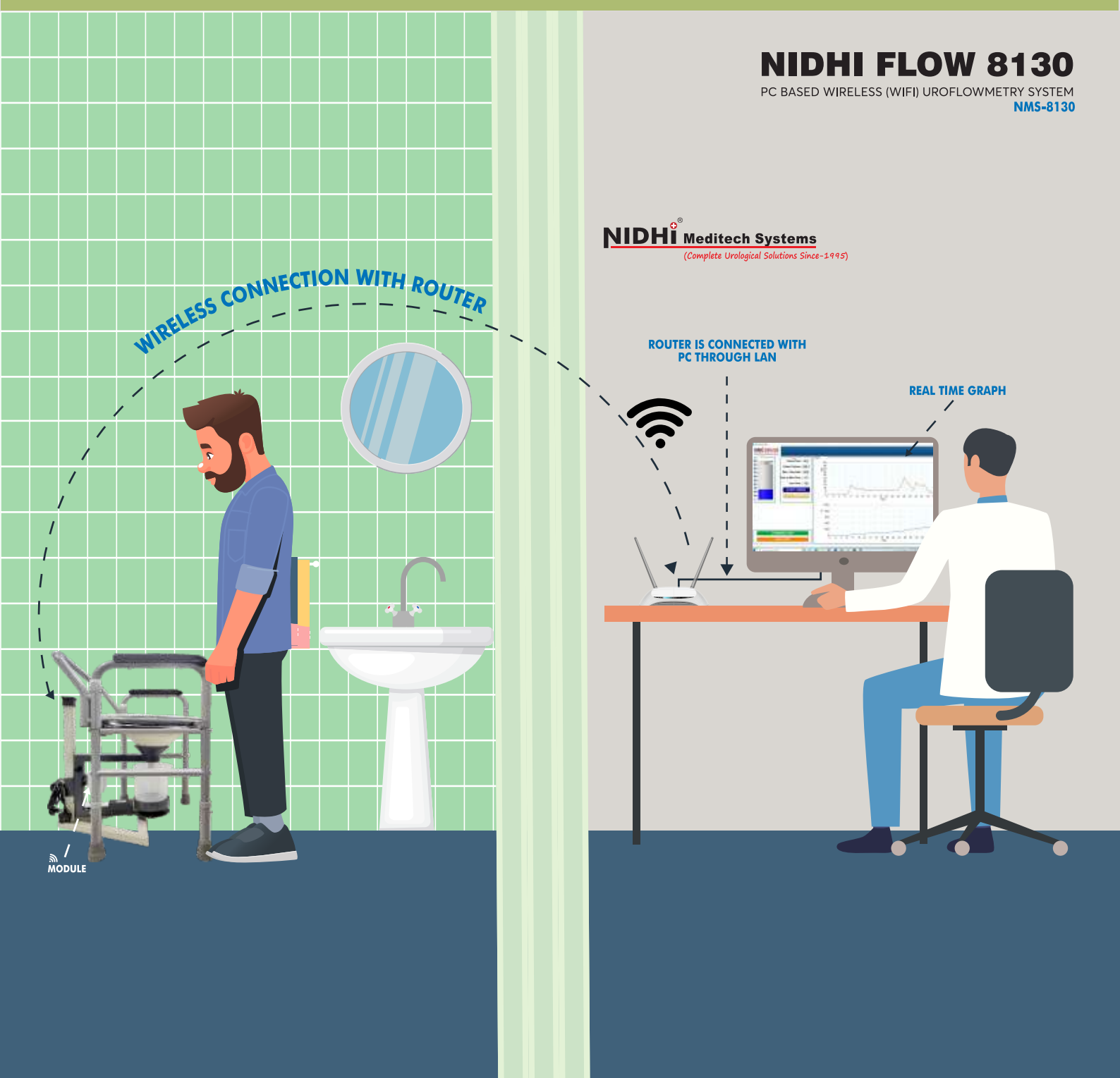

NIDHI FLOW 8130

PC BASED WIRELESS (WIFI) UROFLOWMETRY SYSTEM
NMS-8130

NIDHI[®] Meditech Systems

(Complete Urological Solutions Since-1995)

ROUTER IS CONNECTED WITH
PC THROUGH LAN

REAL TIME GRAPH

MODULE

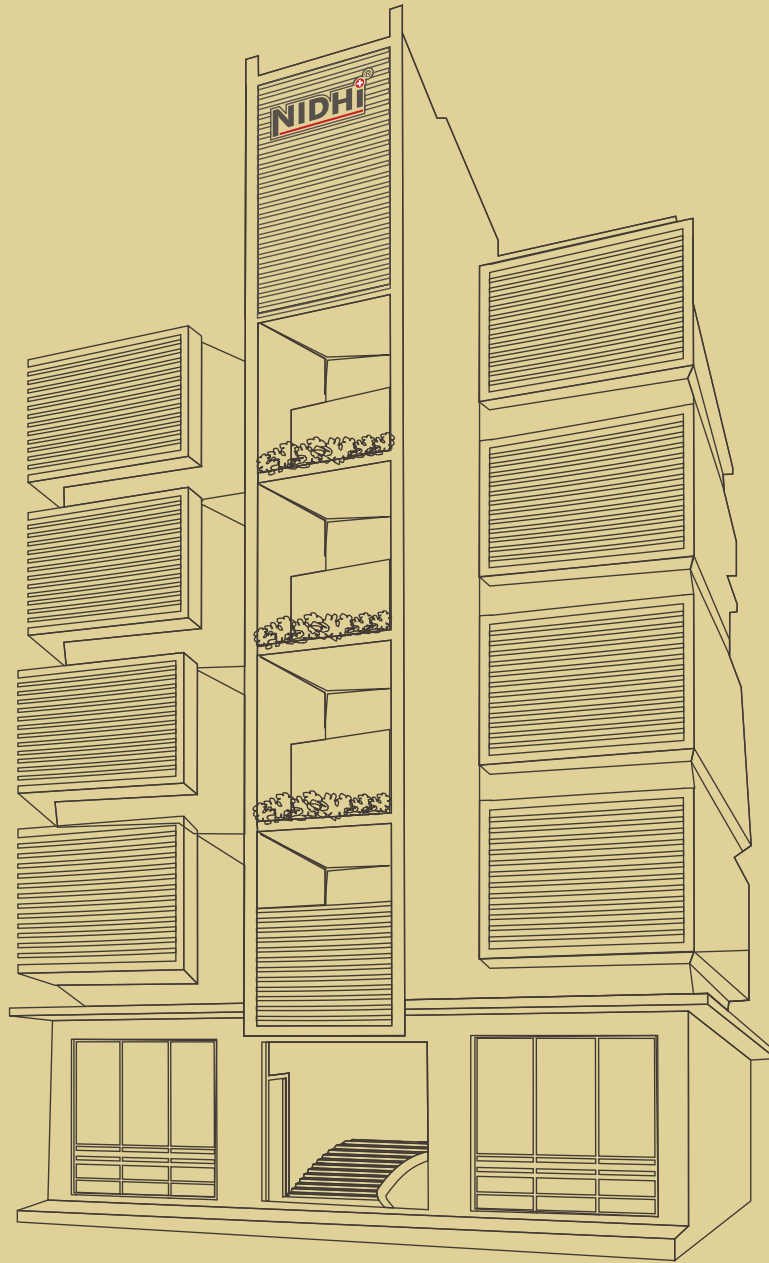

NIDHI[®] Meditech Systems
(Complete Urological Solutions Since-1995)

NIDHI CORPORATE HOUSE

No. H-28, H-29, H-30, Abhishek Estate-3,
Near Asarwa Over Bridge, Opp. Haripura Bus Stop, Haripura, Asarwa, Ahmedabad-380016
Cell / Whatsapp : +91-9510371980
Email : ndshah@nidhimeditech.com, info@nidhimeditech.com, sales@nidhimeditech.com
Website : www.nidhimeditech.com