

NIDHI FLOW 814

PRINTER BASED UROFLOWMETRY SYSTEM



NIDHI FLOW 814

PRINTER BASED UROFLOWMETRY SYSTEM

PROFILE

Uroflowmetry is one way of integrating the activity of the bladder and the outlet during the emptying phase of micturation. The micturation process consists of detrusor function of bladder neck opening and urethral conductivity. Uroflowmetry can establish the type of abnormality and filter the patients who require further invasive procedures. Thus, It avoids under treatment in the younger age group & restricts over zealous invasive procedure in the older age group. The urinary flowrate reflects the final result of the micturation process consisting of detrusor function of bladder neck opening and urethral conductivity. Patient co-operation is essential and psychological discomfort has to be minimized in order to obtain the habitual pattern of micturation during flow measurement.

Parameters Measured

- Voided volume
- Time to max flow
- Voiding time
- Avg. Flow Rate
- Flow time
- Hesitancy
- Max. Flow Rate



Technical Specification

Line Voltage	80V - 230V AC Stabilized
Line Frequency	50Hz
Dimensions (Only uroflow module)	292mmx210mmx110mm(Lx BxH)
Body Type	Uroflow Module made from Rust free Molded ABS Plastic Body
Weight (Only uroflow module)	0.90Kg. (Approx.)
Sansor Type	Digitally controlled piezo resistive weight transducer
Calibration:	User friendly on-site auto Calibration process
Visual Indications (Visual Alarms):	Auto Start, Auto Print , Beaker Full (Over flow)
Repeat Copy	Selectable in two modes-5ml/10ml per second.
Accuracy	±5% of voided volume in reading - ±2 % of voided volume at full range
Maximum Capacity for a single micturation	2000ml
Maximum peak flow rate detectable	50ml/sec.
Voiding time	Standard: 50 seconds Extended up to :-300 seconds
Maximum detectable "Time to Max Flow"	1 second
Printer	Supports to 9 Pin 80 column Dot matrix printer with serial port connectivity

NIDHI FLOW 814

PRINTER BASED UROFLOWMETRY SYSTEM



Micturation Chair with back rest and arm
MICTURATION CHAIR

Micturation Chair & Funnel

Urine Collection Beaker

Standard Accessories

- Advance Microprocessor based Ad-On module
- Transducer
- Micturation Chair with back rest and arms
- Urine collection beaker
- EPSON Compatible Dot matrix Printer

Advanced Microprocessor Based Module
NMS-MD-814



Flow Transducer with cable and connector
NMS-FLT-814



Funnel
NMS-FNL

Epson LX 310 Dot Matrix Printer
Epson-LX-310



OR

TVS MSP 270 Dot Matrix Printer
TVS-MSP-270



Urine Collection Beaker (2000 ML)
NMS-UCB-2 Ltr.

Mains Cable & Printer Cable

NMS-MC-814

NMS-PC-814



UROFLOWMETRY GRAPH

UROFLOW

Start Voiding Now.....

UROFLOWMETRY

PATIENT INFORMATION

PATIENT NAME.....

AGE :.....Years SEX : M / F

POSITION : Standing / Sitting WEIGHT:.....Kg

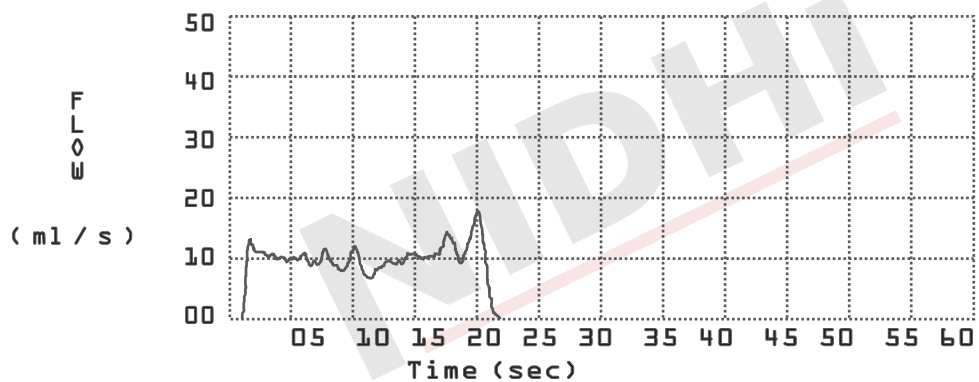

Evaluation :

Voided Volume 232 (ml)
 Max Flow Rate 18 (ml/s)
 Average FlowRate 11 (ml/s)
 Voiding Time 21 (sec)
 Flow Time 21 (sec)
 Time to Max Flow 19 (sec)
 Hesitancy 15 (sec)

Analysis :

Diagnosis :.....

 Advice :.....

ALL STANDARD ACCESSORY OF
NIDHI FLOW 814
PRINTER BASED UROFLOWMETRY SYSTEM
NMS-814



Note: Printer will be either Epson LX 310 OR TVS MSP 270 as per availability...

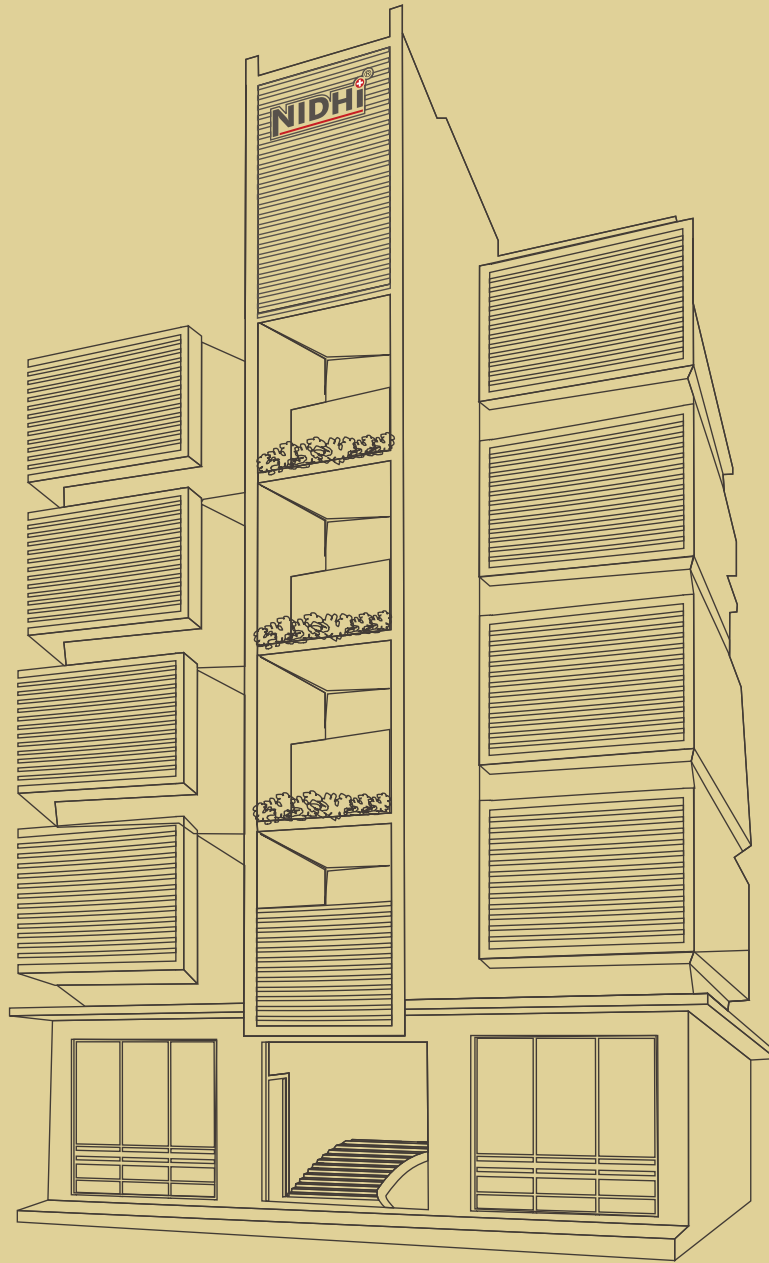

NIDHI[®] Meditech Systems
(Complete Urological Solutions Since-1995)

NIDHI CORPORATE HOUSE

No. H-28, H-29, H-30, Abhishek Estate-3,
Near Asarwa Over Bridge, Opp. Haripura Bus Stop, Haripura, Asarwa, Ahmedabad-380016
Cell / Whatsapp : +91-9510371980
Email : ndshah@nidhimeditech.com, info@nidhimeditech.com, sales@nidhimeditech.com
Website : www.nidhimeditech.com