

NIDHI LITH SEMI DIGI

INTRA CORPOREAL PNEUMATIC LITHOTRIPTER



NIDHI LITH SEMI DIGI

INTRA CORPOREAL PNEUMATIC LITHOTRIPTER NMS-CU-NLSD

"NIDHI LITH SEMI DIGITAL" is a unique device for intra corporeal renal-stone fragmentation by PCNL (Percutaneous Nephrolithotomy) and Ureteric-stone fragmentation by Ureteroscopy via "Direct Contact Lithotripsy" under direct vision endoscopic control.

"NIDHI LITH SEMI DIGITAL" is the intra corporeal lithotripter having supremacy in techno-applicability point of view. It is a most reliable device, found to be an inexpensive and safe form of lithotripsy for fragmenting stones in the kidney, ureter and urinary bladder.

The unit becomes cost effective due to its non-dependancy upon any disposable components, hence proved to be an attractive alternative in today's cost conscious environment.



Features

- Fabricated with rust-proof ABS plastic body.
- Light weight, compact and mobile.
- Single and multiple mode operations.
- In multiple mode, frequency varies from 01 to 12 cycles/sec.
- No possibility of heat generation inside, hence; no chance of any thermal injury.
- Pressure setting knob to set the desired pressure which also facilitates constant monitoring of pressure via pressure dial.
- Most striking feature of NIDHILITH is the rapid and safe fragmentation even of extremely hard calculi in kidney, ureter and bladder by PCNL, Ureteroscopy & Cystoscopy.

PU Air Tubing for Hand Piece of Nidhi Lith Semi Digital**NMS-ST-NLSD****Air Tubing for control unit of Nidhi Lith Semi Digital****NMS-MCT-NLSD****Hand Piece for
NIDHI LITH SEMI Digi NMS-HP-NLSD**

- Light weight.
- Long life.
- Para medical staff can easily dismantle it for maintenance and immediate service.
- Sterilization : Formalin chamber OR Cidex.

**Hand Piece Top
NMS-HPT-URS
NMS-HPT-PCNL****NIDHI LITH SEMI Digi
Foot switch with cable
NMS-FS****Sterilization Cap
NMS-SC**

NIDHI Oxygen Regulator

NMS-OR

Source of Compressed Air: This electro pneumatic device requires the supply of continuous, quiet, clean and dry air pressure. The air source can be procured by three ways i.e. Air compressor, Central Oxygen System, Oxygen Cylinder.

Central Oxygen System : The unit can also be placed on central oxygen system in the hospitals or institutions which can provide the normal pressure to activate the system.

Oxygen Cylinder : This is the very common method to provide air pressure. The NIDHILITH Digi is connected with the oxygen cylinder. For this purpose, we provide oxygen regulator.



PROBE

Standard Accessories Rigid lithotripsy probes are available in all sizes and compatible with any cystoscope, ureteroscope and nephroscope.

Probe (Made from S.S. Alloy-as per ISO-10993 standard)

- Cost effective and durable.
- Sterilization : Formalin chamber OR Cidex.
- Manufacturing standard
IEC-60601 - 1 - 1 IEC-60601 - 1 - 2 ISO 10993 - 2003
- Ureteroscopy Probe (NMS-U-PR)
 - Size : 0.8mm, 1mm, 1.1mm, 1.2mm, 1.4mm, 1.5mm
 - Length : 610mm
- PCNL Probe (NMS-P-PR)
 - Size : 2.0 mm, 2.5mm, 3.0mm
 - Length : 450mm
- Mini PCNL Probe (NMS-MP-PR)
 - Size : 0.8mm, 1mm, 1.1mm, 1.2mm, 1.4mm, 1.5mm
 - Length : 410 mm
- Cystoscopy Probe (NMS-C-PR)
 - Size : 1.5mm
 - Length : 460mm



NIDHI AIR COMPRESSOR - OPTIONAL ACCESSORY

NMS-AC



Technical Specifications

Voltage	230V
Frequency	50 Hz
Max. Pressure	120 PSI
Oil Change	500ml. max.
Speed	2900 RPM
Displacement	45 Lpm Max
Power Consumption	0.325kw/1.8 A
Noise Level	<55 dB

- To be protect from rain and moisture.
- Air Compressor is an optional accessory and not included in all standard accessory.

NMS-TROLLEY

OPTIONAL ACCESSORY



- We also provide trolley made from S.S.Alloy which is required for the better handling of Nidhi Lith Semi Digi along with air compressor.
- Trolley is an optional accessory and not included in all standard accessory.

LITHO BRIDGE FOR BLADDER STONE FRAGMENTATION**OPTIONAL ACCESSORY**

(Compatible with 23.5FR/25Fr Cystoscope Sheath)

NMS-LTB**Technical Specification NIDHI LITH SEMI DIGI**

Supply Voltage	230 VA/ 50Hz/± 10 % / 110 VA C @60 Hz± 10%
Power Consumptions	30 Watts
Input Gas	Oxygen / Compressed Dry Air
In Let Pressure (Minimum) (To Control Unit)	4 Kg / Cms
In Let Pressure (Maximum)(To Control Unit)	6 Kg / Cms
Out Let Pressure Indication	0 - 5 Kg / Cms by Analog Pressure display
Freq. of Impacts	Single Pulse Mode, Continuous Pulse Mode with twelve selectable options.
Control Unit (Made from rust free molded ABS plastic body)	Size : L 195mm X W 240mm X H 125mm Weight : 1930 gms
Hand Piece (Made from Aluminum Alloy)	Weight : 105 gms

ALL STANDARD ACCESSORY OF

NIDHI LITH SEMI DIGI NMS-NLSD



**CONTROL
UNIT**
01

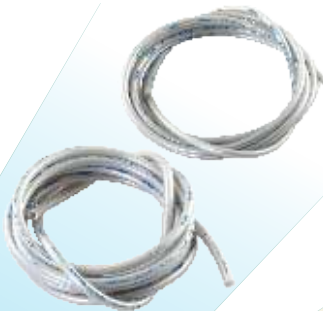

**PNUMETIC TUBING CONNECT
WITH CONTROL UNIT**
01

**PNUMETIC TUBING
CONNECT WITH
HAND PIECE**
01



**FOOT
SWITCH**
02

NIDHI⁺
NIDHI LITH SEMI DIGI



PROBES
06

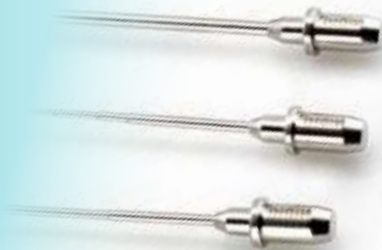

HANDPIECE
02



**OXYGEN
REGULATOR**
01



**MAINS
CABLE**
01



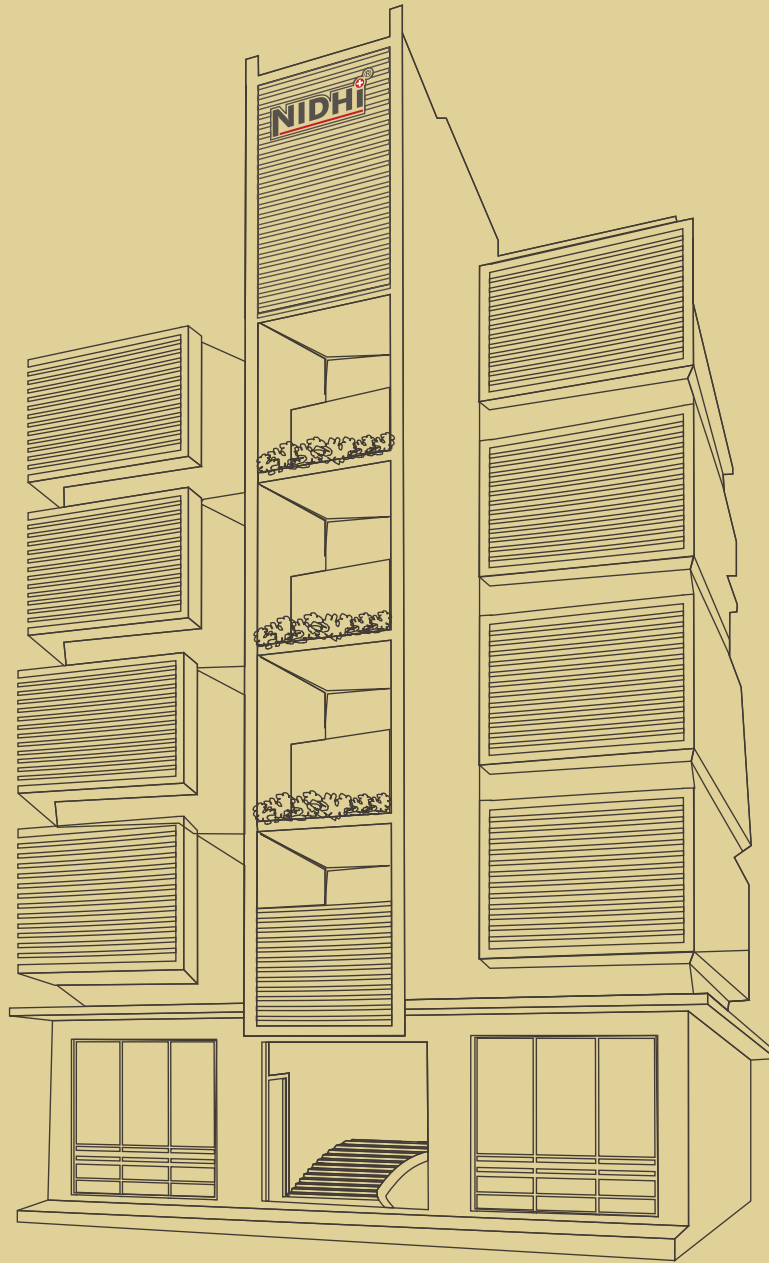

NIDHI⁺ Meditech Systems
(Complete Urological Solutions Since-1995)

NIDHI CORPORATE HOUSE

No. H-28, H-29, H-30, Abhishek Estate-3,
Near Asarwa Over Bridge, Opp. Haripura Bus Stop, Haripura, Asarwa, Ahmedabad-380016
Cell / Whatsapp : +91-9510371980
Email : ndshah@nidhimeditech.com, info@nidhimeditech.com, sales@nidhimeditech.com
Website : www.nidhimeditech.com