

## NIDHI LITH DIGI

INTRA CORPOREAL PNEUMATIC LITHOTRIPTER



INTRA CORPOREAL PNEUMATIC LITHOTRIPTER

# NIDHI LITH DIGI CONTROL UNIT NMS-CU-NLD

## Most Striking Feature

- The vital feature of the NIDHI LITH-Digi is, the system transmits the pulses only after selection of the desired mode from the front panel and thereby eliminating a risk of injury due to accidental pressing of the foot switch during surgical procedure.
- Digitally controlled flow and pressure device generates highly accurate pulses in the form of single pulse operating mode and continuous pulse operating mode. It is used to control power to the hand piece for better stone fragmentation.



## Features

- "NIDHILITH" Digi is a unique device for intra corporeal stone fragmentation by "Direct Contact Lithotripsy" under direct vision endoscopic control.
- "NIDHILITH" Digi is the intra corporeal lithotripter having supremacy in techno-applicability point of view. It is a most reliable device, found to be an inexpensive and safe form of lithotripsy for fragmenting stones in the kidney, ureter and urinary bladder
- Attractive control unit molded with ABC plastic body.
- Light weight, compact and mobile.
- Design of master hand piece and digitally controlled flow and pressure device of NIDHI LITH-Digi provides minimum excursion and bilateral movement of the probe, so it gives safety to endoscope and avoid possible stone migrations.
- No possibility of heat generation inside, hence; no chance of any thermal injury.
- Pressure setting knob is to set the desired pressure, which also facilitates constant monitoring of pressure by display.
- Single and multiple mode operations. In multiple modes, twelve options are available to change the frequency from 1 pulse/second to 12 pulses/seconds

Soft PU Air Tubing To Connect With Hand Piece with Connector

### NMS-ST-NLD



Air tubing to connect with control unit with Connector

### NMS-MCT-NLD



### Hand Piece for NIDHI LITH Digi NMS-HP-NLD

- Light weight.
- Long life.
- Para medical staff can easily dismantle it for maintenance and immediate service.
- Sterilization : Formalin chamber OR Cidex.



Hand Piece Top  
**NMS-HPT-URS**  
**NMS-HPT-PCNL**



NIDHI LITH Digi  
Foot switch with cable  
**NMS-FS**



Sterilization Cap  
**NMS-SC**



## NIDHI Oxygen Regulator

# NMS-OR

**Source of Compressed Air:** This electro pneumatic device requires the supply of continuous, quiet, clean and dry air pressure. The air source can be procured by three ways i.e. Air compressor, Central Oxygen System, Oxygen Cylinder.

**Central Oxygen System :** The unit can also be placed on central oxygen system in the hospitals or institutions which can provide the normal pressure to activate the system.

**Oxygen Cylinder :** This is the very common method to provide air pressure. The NIDHILITH Digi is connected with the oxygen cylinder. For this purpose, we provide oxygen regulator.



## PROBE | Standard Accessories Rigid lithotripsy probes are available in all sizes and compatible with any cystoscope, ureteroscope and nephroscope.

### Probe (Made from S.S. Alloy-as per ISO-10993 standard)

- Cost effective and durable.
- Sterilization : Formalin chamber OR Cidex.
- Manufacturing standard  
IEC-60601 - 1 - 1 IEC-60601 - 1 - 2 ISO 10993 - 2003
- Ureteroscopy Probe (NMS-U-PR)
  - Size : 0.8mm, 1mm, 1.1mm, 1.2mm, 1.4mm, 1.5mm
  - Length : 610mm
- PCNL Probe (NMS-P-PR)
  - Size : 2.0 mm, 2.5mm, 3.0mm
  - Length : 450mm
- Mini PCNL Probe (NMS-MP-PR)
  - Size : 0.8mm, 1mm, 1.1mm, 1.2mm, 1.4mm, 1.5mm
  - Length : 410 mm
- Cystoscopy Probe (NMS-C-PR)
  - Size : 1.5mm
  - Length : 460mm



**NIDHI AIR COMPRESSOR - OPTIONAL ACCESSORY****NMS-AC****Technical Specifications**

Voltage	230V
Frequency	50 Hz
Max. Pressure	120 PSI
Oil Change	500ml. max.
Speed	2900 RPM
Displacement	45 Lpm Max
Power Consumption	0.325kw/1.8 A
Noise Level	<55 dB

- To be protect from rain and moisture.
- Air Compressor is an optional accessory and not included in all standard accessory.

**NMS-TROLLEY** OPTIONAL ACCESSORY

- We also provide trolley made from S.S.Alloy which is required for the better handling of Nidhi Lith Digi along with air compressor.
- Trolley is an optional accessory and not included in all standard accessory.

## LITHO BRIDGE FOR BLADDER STONE FRAGMENTATION OPTIONAL ACCESSORY

(Compatible with 23.5FR/25Fr Cystoscope Sheath)

### **NMS-LTB**



#### **Technical Specification for NIDHI LITH DIGI**

Supply Voltage	230 VA/ 50Hz/± 10 % / 110 VA C @60 Hz± 10%
Power Consumption	30 Watts
Input Gas	Oxygen / Compressed Dry Air
In Let Pressure (Minimum) (To Control Unit)	4 Kg / Cms
In Let Pressure (Maximum)(To Control Unit)	6 Kg / Cms
Out Let Pressure Indication	0 - 5 Kg / Cms by Digital display
Freq. of Impacts	Single Pulse Mode, Continuous Pulse Mode with twelve selectable options.
Control Unit (Made from rust free molded ABS plastic body)	Size : L 195mm X W 240mm X H 125mm Weight : 1930 gms
Hand Piece (Made from Aluminum Alloy)	Weight : 105 gms

ALL STANDARD ACCESSORY OF

# NIDHI LITH DIGI NMS-NLD

**HANDPIECE**  
02

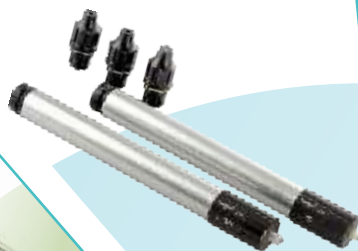

**OXYGEN  
REGULATOR**  
01



**MAINS  
CABLE**  
01



**PROBES**  
06



**FOOT  
SWITCH**  
02



**PNUMETIC TUBING  
CONNECT WITH  
CONTROL UNIT**

01



**PNUMETIC TUBING  
CONNECT WITH  
HAND PIECE**

01



**CONTROL  
UNIT**  
01



**NIDHI<sup>+</sup>**  
**NIDHI LITH DIGI**



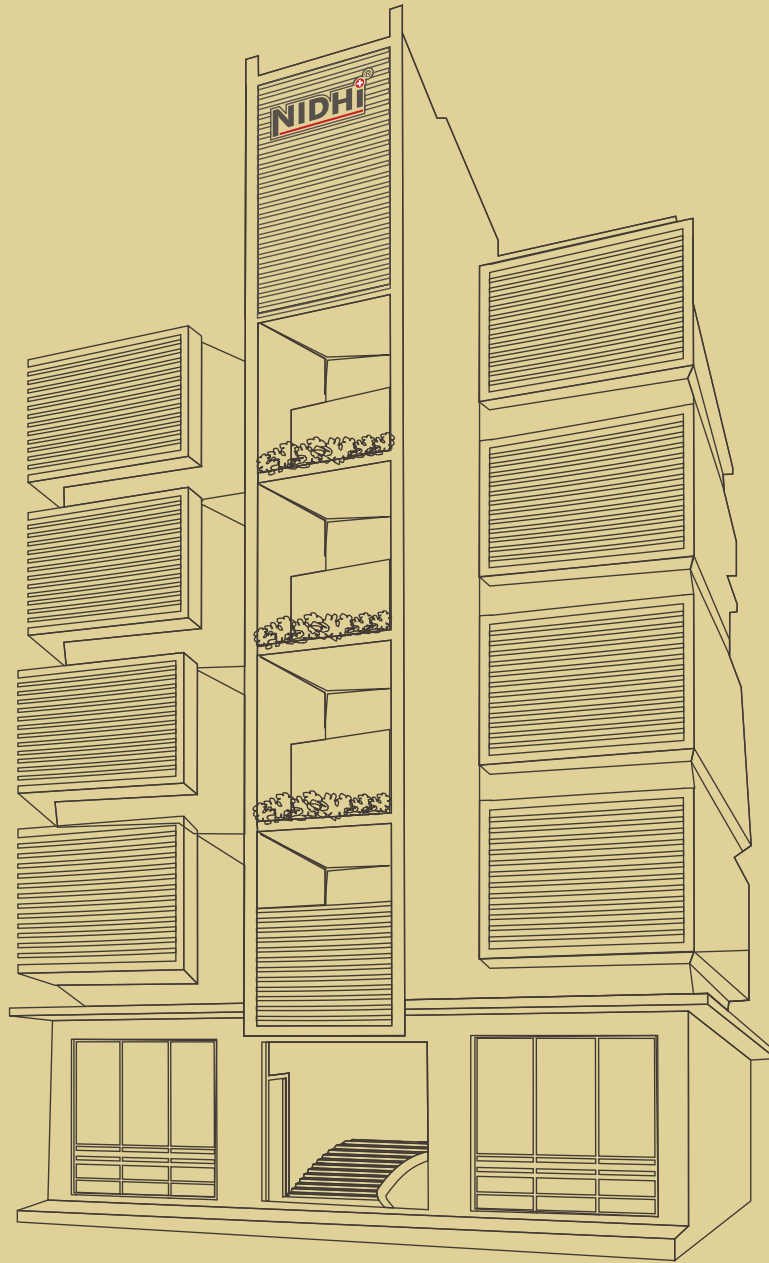

**NIDHI<sup>®</sup> Meditech Systems**  
(Complete Urological Solutions Since-1995)

**NIDHI CORPORATE HOUSE**

No. H-28, H-29, H-30, Abhishek Estate-3,  
Near Asarwa Over Bridge, Opp. Haripura Bus Stop, Haripura, Asarwa, Ahmedabad-380016  
Cell / Whatsapp : +91-9510371980  
Email : [ndshah@nidhimeditech.com](mailto:ndshah@nidhimeditech.com), [info@nidhimeditech.com](mailto:info@nidhimeditech.com), [sales@nidhimeditech.com](mailto:sales@nidhimeditech.com)  
Website : [www.nidhimeditech.com](http://www.nidhimeditech.com)